



**SOCIETY OF
ASSOCIATION
EXECUTIVES**



Hosted by



INAUGURAL CONCLAVE

SOCIETY OF ASSOCIATION EXECUTIVES 2026, MUMBAI

THEME: BUILDING STRONGER ASSOCIATIONS FOR A FAST-DEVELOPING INDIA

**26th - 27th June | Jio World Convention Centre,
2026 | BKC, Mumbai**

ANNOUNCEMENT BROCHURE

Association
Support Partner



Media Partner



Organised by



Welcome Message

Distinguished colleagues and friends, thank you for gathering with us today to mark the launch of the Society of Association Executives. It is a profound honour to stand before so many respected leaders who have shaped our institutions, our professions, and our shared public life.

We launch this Society with a clear and urgent purpose: to professionalise and uplift association management across India and beyond. Our commitment is simple but bold - to promote the highest standards of competence, ethics and integrity; to create continuous learning and mentorship pathways for current and future leaders; to advocate for fair recognition of our profession in every forum of governance; and to foster diversity, equity and inclusion in everything we do. Equally important, we will actively work toward the amalgamation of Indian and international societies so that our members benefit from global best practice while making our own distinct contributions to the international community.

This Society will be a practical instrument - not a talking shop. We will set standards, deliver accredited learning, convene timely conversations, and build networks that turn ideas into outcomes. We will help associations improve governance, sharpen strategy, and strengthen the vital services they provide to communities, professionals and citizens.

But institutions are only as strong as the people who bring them to life. I invite each of you - seasoned practitioners, institutional leaders and partners - to join us as mentors, advisers, contributors and critics. Help us keep the Society rigorous, relevant and responsive. Together, let us raise the bar for association leadership and demonstrate how professional stewardship can multiply impact. Thank you for your faith, your time and your partnership. I look forward to building this future with you.



Dr. Ramesh S Bilimagga
President,
Society of Association Executives (SAE)
Emeritus Professor
Group Head, Radiation Oncology
Healthcare Global Enterprises
Past President of AROI, ISO, IAHOM, IBS
FSHI & ROTARY CITY CENTRE, Bengaluru



Dr. Ishwar Gilada
General Secretary,
Society of Association Executives (SAE)
Emeritus, AIDS Society of India
(ASI) & Governing Council Member,
International AIDS Society (IAS)
Current workplace: Unison Medicare &
Research Centre, Mumbai





About SAE

Building Stronger Associations for a Fast-Developing India

The Society of Association Executives India is bringing the association community together for its inaugural Conclave, a two-day gathering designed to strengthen leadership, accelerate learning, and support associations in building modern, resilient, and member-driven organizations. This first Conclave sets the tone for SAE India's role as a connector, convenor, and capacity-builder, bringing together leaders from India alongside international association voices from Africa, Europe, and Asia to exchange practical ideas and develop solutions to shared challenges.

The Society of Association Executives launched in **August 2025**



“Uniting associations on a single platform is a powerful step toward fostering collaboration, strengthening networks, and driving meaningful academic growth.”

- Dr. Dixit,
Past President,
ISCCM & Secretary,
Sepsis Forum of India





Partners & Hosts

The conclave being organised in collaboration with a distinguished network of Partners and Hosts as they share our vision of fostering innovation, knowledge exchange, and professional development, and are playing a key role in supporting the event's growth and impact. As Partners and Hosts, they contribute to enhancing delegate engagement and strengthening industry participation. Their association with the conclave reflects a shared commitment to advancing the field and creating a vibrant platform for networking, learning, and collaboration.



Jio World Convention Centre (JWCC)



Airport

Chhatrapati Shivaji Maharaj International Airport
30 minute drive



Metro

Bandra Kurla Complex Metro Station Aqua Line - 3
7-10 minute walk

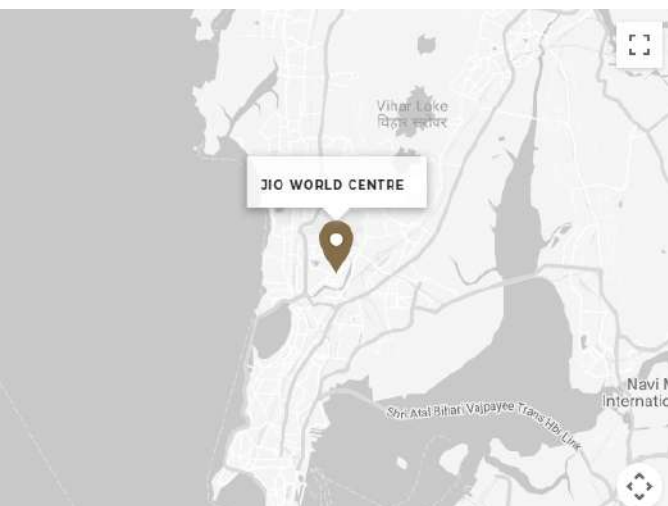
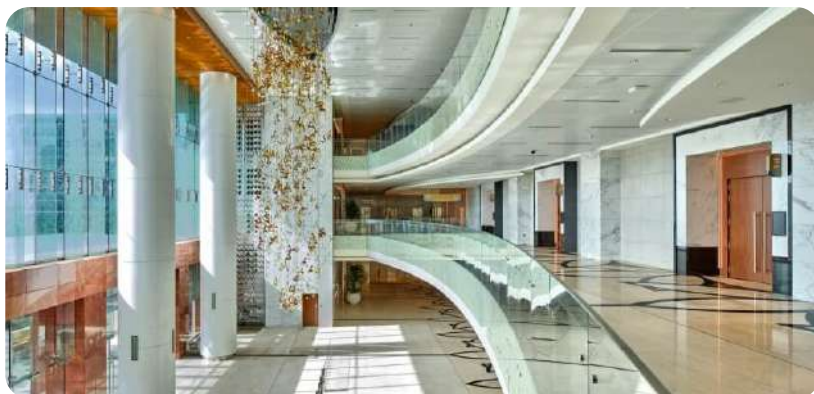

Click on map for location



Governing Council Members



Dr. Ramesh S Bilimagga

President,
Society of Association Executives (SAE)
Emeritus Professor
Group Head, Radiation Oncology
Healthcare Global Enterprises
Past President of AROI, ISO, IAHOME, IBS
FSHI & ROTARY CITY CENTRE, Bengaluru



Dr. Ishwar Gilada

General Secretary,
Society of Association Executives (SAE)
Emeritus, AIDS Society of India
(ASI) & Governing Council Member,
International AIDS Society (IAS)
Current workplace: Unison Medicare &
Research Centre, Mumbai



Dr. Srinivas K G

Treasurer,
Society of Association Executives (SAE)
Director,
Oncology services and
Senior Consultant Medical Oncologist
ClearMedi Radiant Hospital,
Mysore



Dr. T. Thanga Mariappan

Board Member,
Society of Association Executives (SAE)
President, Society for the Study
of Xenobiotics (SSX-India),
Bengaluru



Mr. Pradeep Mittal

Board Member,
Society of Association Executives (SAE)
Chairman-Foundry Informatic
Center, New Delhi
Current work place
PP Associates, Noida



Dr. J. Raghunand Sindhe

Board Member,
Society of Association Executives (SAE)
Head of Dental Rehabilitative Oncology,
Healthcare Global Enterprises,
Bengaluru

Advisor



Dr. Harsh Sapra

Board Member,
Society of Association Executives (SAE)
Society of Neurocritical Care India
Current workplace:
Medanta, The Medicity Hospital,
Gurugram



Ms. Renuka Singh

Consultant - External
Relations, Confederation
of Indian Industry,
New Delhi



Organising Committee



Kalpana Uberoi
Business Head
GConvene



Gregg H. Talley
Chief Executive Officer
Talley Management Group



Ksenija Polla
Director,
International Development
Talley Management Group



Umesh K Anandani
Executive Director,
Society of Association Executives (SAE)





Conclave Highlights

DAY 1

26th June 2026

Conclave opening and vision setting for SAE India

Global perspectives from association leaders across Europe, Africa, and Asia

Board governance strategies for stronger alignment and decision-making

Membership growth and retention best practices

Interactive exchange on challenges and successes in Indian associations

Strategies for building non-dues revenue and partnerships

Designing high-value programs members are willing to pay for

Panel discussion on collaboration between government and associations

Day 1 wrap-up and Day 2 workshop track selection

DAY 2

27th June 2026

Welcome back and workshop orientation

Membership and value proposition clinic with actionable outputs

Hands-on development of member engagement and retention plans

Program and revenue design sprint for new offerings

Building pricing models and pilot plans for new programs

Creation of practical templates and implementation-ready strategies

Conclave commitments and next steps for SAE India community

*Note: For the latest program information and speaker updates,

visit: www.saexecutives.com

Registration Fee

Category	Early Bird Till 15 th May 2026	Regular 16 th May - 25 th June 2026	On-Spot 26 th June 2026 Onwards
Delegate Member	INR 6800 (GST 18% Included)	INR 8075 (GST 18% Included)	INR 10200 (GST 18% Included)
Delegate Non-Member	INR 8000 (GST 18% Included)	INR 9500 (GST 18% Included)	INR 12000 (GST 18% Included)

Click here to

REGISTER NOW

Click here to

BECOME AN SAE MEMBER

Note : SAE Members are eligible for 15% Discount on the above registration fee.

Terms & Conditions

- Registration for the conference will be confirmed only after receipt of full payment.
- All participants must register individually using the official online registration portal.
- The organising committee reserves the right to make changes to the conference program, speakers, venues, or timing if necessary.
- Delegates are responsible for registering under the correct category.
- A receipt will be issued upon online successful payment.
- All registration fees are inclusive of 18%GST, and an online transaction fee shall be added during the online payment.
- Any additional bank or transaction charges are the responsibility of the registrant.

Cancellation & Refund Policy

- All cancellations must be made in writing and emailed to the conference secretariat at secretariat@saexecutives.com (Cancellations will be acknowledged via email once processed).
- Till 31st May 2026: 50% refund of registration fee (after deducting administrative and GST charges).
- After 31st May 2026: No refund will be provided.
- No refunds will be provided for non-attendance without prior notice.
- Refunds will be process within 30 days after the conference
- In the unlikely event that the conference is cancelled or postponed due to circumstances beyond the control of the organizers, the liability of the organising committee is limited to the refund of registration fees only. Travel, accommodation, and other incidental costs will not be reimbursed.

Reason To Participate as Delegate

Expanded Networking

Network with leadership and senior management of associations and societies, opening doors to collaborative ventures and shared best practices.

Presence of global international associations and societies from Europe, Africa, and Asia fosters cross-continental partnerships tailored to Indian convention needs.

Interact with key partners and exhibitors from across the convention ecosystem, securing sponsorships and innovations for your events.

Expert Engagement

Meet and engage with international and national speakers, gaining actionable insights on convention eco-system in India.

Presence of renowned international and national Key Opinion Leaders provides delegate-only access to Q&A, elevating your expertise in conference programming.

Engaging workshops deliver hands-on skills in event logistics, sponsorship strategies, and attendee hospitality relevant to large conferences and conventions in India.

Strategic Connections Opportunities

- **Direct Access To Build Your Network:** Meet representatives and senior officials from hotels, tourism boards, associations, government bodies, and convention leaders face-to-face.
- **Engage and Connect:** Join discussions, share ideas, and find partners to build strong relationships.
- **Boost Your Business:** Gain insights on MICE tech and trends to elevate your events. Turn contacts into deals, collaborations, and new opportunities.

Professional Growth

As a delegate, access exclusive sessions on association governance and executive strategies, directly benefiting Society of Association Executives members.

Build a personal network of influencers to amplify your role in Indian convention industry.

Return with fresh ideas to drive innovation, membership growth, and event success for your teams.

Who Should Attend?

CEOs

Presidents

Chairpersons

General Secretaries

Board Members

Professional Staff

Young Professionals

Industry Partners

Consultants

Organisations

Trade Bodies

Non-Government
Institutions

Professional Societies



Why Join SAE

- Access to a global network of association professionals, leaders, and decision-makers.
- Opportunities to collaborate, exchange insights, and strengthen alliances with peers and industry influencers.
- Learning forums and leadership sessions are designed to address real-world challenges faced by association executives.
- Exposure to international trends, technologies, and strategies shaping the future of associations.
- Increased visibility and recognition for your organization within the association ecosystem, and enhanced understanding of association values and their impact across India.
- Join the global community of association professionals, including potential collaborations with other societies such as the African Society of Association Executives and the American Society of Association Executives.



Membership Opportunities

SAE offers diverse membership opportunities designed to serve the needs of professionals, partners and organizations across the association ecosystem. Each category is tailored with exclusive benefits, resources and opportunities to maximize value for members.

Membership Categories:

- CEOs
- Professional Staff
- Young Professionals
- Industry Partners
- Consultants
- Organizations

Membership Benefits Includes:

- Discounted passes to participate in all SAE Meetings.
- Privileged membership
- Opportunity to meet and network with peers and other suppliers/ partners involved in association management.
- Access to member directory.
- Members would enjoy voting rights to elect the board members.
- Opportunity to contest for association awards.
- Opportunities to earn CAE {Certified Association Executive} professional development hours.
- Opportunity to get certified by SAE for the CAE program.
- To participate as hosted buyer in SAE sponsored events.
- Membership management and enhancement, application tools for membership management, skill development, Industry liaison, Government liaison, access to Newsletters.
- Opportunity to advertise on our website, in our meeting programs, and/or in our Annual Membership Directory at discounted rates.
- Access to curated industry news, leadership resources, and professional development Opportunities through E-Newsletters

CEOs

Leaders of Associations and AMCs

Who Can Join?

- Chief Executive Officers (CEOs) and top executives of associations and association management companies (AMCs)
- Senior leaders responsible for strategic decision-making and organizational growth

Benefits Include:

- Exclusive networking with peer CEOs and senior association leaders
- Access to SAE leadership forums, roundtables, and strategy sessions
- Insights into global trends, best practices, and benchmarking tools
- Opportunities to influence SAE initiatives and industry advocacy
- Recognition through SAE leadership programs and awards
- Priority access to conferences, workshops, and executive development programs

Annual Membership Fee: **INR 9,500/-**

Professional Staff

Employees of Associations

Who Can Join?

- Mid-level professionals working in functional roles, such as Finance, Events, Communications, Operations.

Benefits Include:

- Networking with association professionals across sectors
- Access to SAE directories, knowledge resources and newsletters
- Professional development opportunities, including CAE credits
- Invitations to SAE learning forums and leadership programs
- Opportunities to showcase work and engage through SAE platforms

Annual Membership Fee: **INR 6,000/-**

Young Professionals

Who Can Join?

- Association professionals aged 35 and under
- Early-career leaders aspiring to grow in association management

Benefits Include:

- Discounted membership rates
- Mentorship and peer-learning opportunities with senior executives
- Invitations to SAE networking events and career-focused workshops
- Access to resources and development programs designed for emerging leaders
- Recognition opportunities through SAE awards and platforms

Annual Membership Fee: **INR 3,000/-**

Industry Partners Suppliers to Associations

Who Can Join?

- Hotels
- Convention Centers
- Professional Conference Organizers
- Event Service Providers
- Technology Companies Publishers
- Suppliers Supporting Associations

Benefits Include:

- **Unlock New Business Avenues:** Join the association for exclusive leads, partnerships, and growth through member networks and events.
- **Exclusive Access:** Get invites to member-only events, directories, and forums where deals are made.
- **Lead Generation:** Tap into a vetted network of 300+ delegates for partnerships and referrals.
- **Credibility Boost:** Use association branding in pitches to win sponsors, venues, or clients in MICE/medical sectors and non-medical sectors.
- **Ongoing Support:** Receive updates and intros to hotels, bureaus, and govt bodies for repeat business.
- Use of the official “**SAE Industry Partner**” badge
- Opportunities to participate in discussion forums and SAE showcase events
- **Priority Advertising & Branding:** Secure prime spots in SAE event brochures, websites, newsletters, and on-site banners/backdrops—plus logo placement in all promotional materials.
- Direct access to association executives and decision-makers

Annual Membership Fee: **INR 15,000/-**

Consultants

Non-Association Executives

Who Can Join?

- Independent Consultants and Advisory Firms
- Non-Association Executives providing Services Strategy for Marketing, HR, Finance and Training.

Benefits Include:

- Access to SAE's professional community and directories
- Targeted networking with 300+ leaders: Connect one-on-one with association executives and senior officials and representative from Hotels, Tourism Boards, Trade Bodies, MICE partners through sessions, dinner and exhibition —turning conversations into deals, collaborations, and long-term partnerships.
- Invitations to knowledge-sharing forums, seminars and roundtables
- Opportunities to contribute expertise through SAE publications and events
- Visibility through SAE's communication channels

Annual Membership Fee: **INR 9,500/-**



Organizations

Who Can Join?

- Leaders aspiring to grow in association management

Benefits Include:

- Networking with association professionals across sectors
- Access to SAE directories, knowledge resources and newsletters
- Professional development opportunities, including CAE credits
- Invitations to SAE learning forums and leadership programs
- Opportunities to showcase work and engage through SAE platforms

Small Organization

Executive Committee / Staffs (1-9)

- 1-2 Members: **INR 11,000/-**
- 3-6 Members: **INR 22,000/-**
- 7-9 Members: **INR 44,000/-**

Medium Organization

Executive Committee / Staffs (10-49)

- 10-19 Members: **INR 88,000/-**
- 20-29 Members: **INR 99,000/-**
- 30-39 Members: **INR 1,11,000/-**
- 40-49 Members: **INR 1,22,000/-**

Large Organization

Executive Committee / Staff (50+)

- 50-74 Members: **INR 1,44,000/-**
- 75-99 Members: **INR 1,88,000/-**



About Host City - Mumbai

Mumbai, formerly known as Bombay, is India's largest city and financial powerhouse. Situated on the west coast of India, Mumbai is a melting pot of cultures, diversity, and contrasts. It serves as the commercial, entertainment, and fashion capital of the country, pulsating with energy and vitality.

Mumbai, the capital of Maharashtra state is India's largest city with a population of over 20.6 million it is equivalent to the population of so many countries of the world. Mumbai is set to be the world's second largest urban conglomeration by 2025. Mumbai is the commercial capital of India.

Renowned for its iconic landmarks such as the Gateway of India, Marine Drive, and the historic Chhatrapati Shivaji Maharaj Terminus, Mumbai seamlessly blends its colonial past with modern aspirations. The city's skyline is adorned with towering skyscrapers, reflecting its status as a global business hub.

Mumbai is not just about its economic prowess; it is also a cultural hotspot. The city is home to Bollywood, the world's largest film industry, where dreams are woven into celluloid. From its vibrant street food scene to its upscale restaurants, Mumbai tantalizes taste buds with its culinary delights, including the famous vada pav and pav bhaji.

Gateway of India

An iconic landmark of Mumbai. Although it's a bit of a drive from Sahar, it's a must-see for first-time visitors. Built in the 20th Century to commemorate the visit of King George V and Queen Mary, overlooking the Mumbai harbour.



Bandra-Worli Sea Link

A 5.6 km long, 8-lane wide cable-stayed bridge linking Bandra with Worli.



Kala Ghoda

Famous for art festivals, quirky boutiques and charming restaurants in South Mumbai.



Mumbai Beach

Popular beaches include Juhu and Chowpatty, known for street food and sunset views.

Elephanta Caves

One of the oldest rock-cut cave structures, showcasing Lord Shiva sculptures (6th–8th century). Famous for ancient rock-cut temples and sculptures. You can take a ferry from the Gateway of India to reach the caves.



Atal Setu

India's longest sea bridge, 22 km long, inaugurated recently to connect Mumbai to South India.

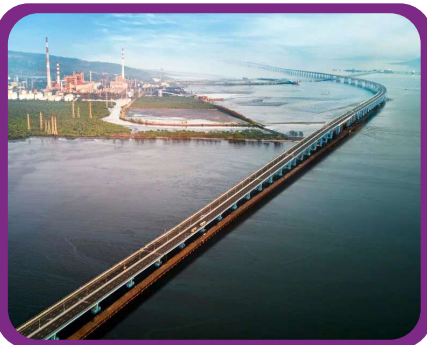

Bandra Kurla Complex

A prominent business district that also has high-end shopping, dining, and the Mumbai Metropolitan Region Development Authority (MMRDA) Grounds, which hosts various events.



Phoenix Marketcity

A large shopping mall with a variety of international and local brands, dining options, and entertainment facilities. It's a short drive from the hotel.



Colaba Causeway Market

Street shopping hub with clothes, boutiques, British-era buildings and eateries.



